

**TFI..**

No.	A	D	L	L1	SW	VPE
TFI1/810	1/8" BSP	10	33	8	14	25
TFI1/410	1/4" BSP	10	33	8	17	25
TFIM1410	M14x1,5	10	32	10	17	10
TFI1/413	1/4" BSP	13	39	8	17	25
TFIM1613	M16x1,5	13	40	10,5	22	10
TFI3/813	3/8" BSP	13	40	8	19	25

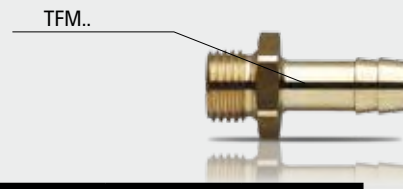
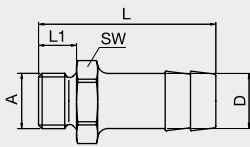

**TFM..**

No.	A	D	L	L1	SW	VPE
TFM810	M8x0,75	10	33,5	7	11	25
TFM1010	M10x1	10	33,5	7	11	25
TF1/810	1/8" BSP	10	33	7	14	25
TF1/410	1/4" BSP	10	35	9	17	25
TFM1213	M12x1,5	13	40	9	15	25
TF1/413	1/4" BSP	13	42	9	17	25
TFM1413	M14x1,5	13	43	10	17	10
TFM1613	M16x1,5	13	40	9	17	10
TF3/813	3/8" BSP	13	42	9	19	25
TFM2419	M24x1,5	19	56	16	27	10
TF1/219	1/2" BSP	19	54	12	24	10
TF3/419	3/4" BSP	19	60	16	32	10

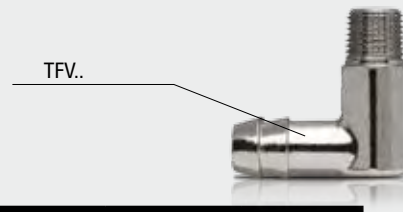
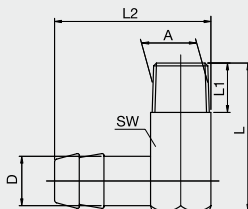

**TFV..**

No.	A	D	L	L1	L2	SW	VPE
TFVM810	M8x0,75	10	27	9	33,5	11	25
TFVM1010	M10x1	10	27	9	28,5	11	25
TFV1/810*	1/8" BSP	10	27	9	28,5	11	25
TFV1/410*	1/4" BSP	10	34	11	40	15	25
TFV1/413*	1/4" BSP	13	34	11	40	15	25
TFVM1413	M14x1,5	13	34	11	40	15	10
TFV3/813*	3/8" BSP	13	35	12	42	17	25
TFVM2419	M24x1,5	19	47	16	58,5	24	10
TFV1/219*	1/2" BSP	19	47	16	58,5	24	10

\* Nickel plated / vernickelt / nickelé

: ]h]b[ g  
Ni V\ “f  
5 WWggc]fYg

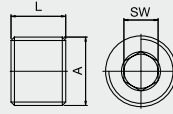
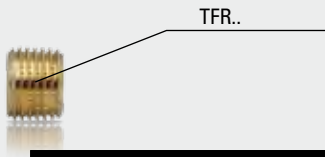

**TFR..**  
**conical**

No.	A	L	SW	VPE
TFRM8	M8x0,75	8	4	100
TFRM10	M10x1	8	5	100
TFR1/8*	1/8" BSPT	8	5	100
TFRM12	M12x1,5	8	6	100
TFR1/4*	1/4" BSPT	10	7	100
TFRM14	M14x1,5	10	7	100
TFR3/8*	3/8" BSPT	10	8	100
TFR1/2*	1/2" BSPT	10	10	100

\* Nickel plated / vernickelt / nickelé

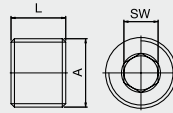
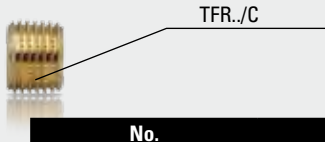

**TFR../C**  
**cylindrical**

No.	A	L	SW	VPE
TFRM8C	M8x0,75	8	4	100
TFRM10C	M10x1	8	5	100
TFR1/8C*	1/8" BSP	8	5	100
TFRM12C	M12x1,5	8	6	100
TFR1/4C*	1/4" BSP	10	7	100
TFRM14C	M14x1,5	10	7	100
TFR3/8C*	3/8" BSP	10	8	100
TFR1/2C*	1/2" BSP	10	10	100

\* Nickel plated / vernickelt / nickelé

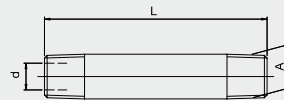

**TF..**

No.	T	L	d	VPE
TF1/8/50	1/8" BSPT	50	6	10
TF1/8/100	1/8" BSPT	100	6	10
TF1/8/150	1/8" BSPT	150	6	10
TF1/8/200	1/8" BSPT	200	6	10
TF1/4/50	1/4" BSPT	50	9	10
TF1/4/100	1/4" BSPT	100	9	10
TF1/4/150	1/4" BSPT	150	9	10
TF1/4/200	1/4" BSPT	200	9	10
TF3/8/100	3/8" BSPT	100	12	10
TF3/8/150	3/8" BSPT	150	12	10
TF3/8/200	3/8" BSPT	200	12	10

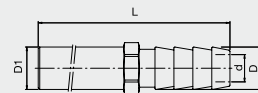
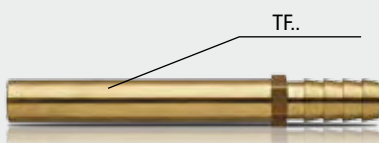

**TF..**

No.	D	D1	d	L	SW	VPE
TF10/120	10	10	6	120	11	10
TF10/240	10	10	8	240	11	10
TF13/150	13	14	9	150	15	10
TF13/300	13	14	9	300	15	10

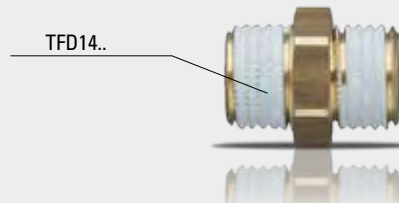
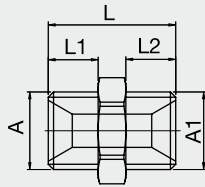

**TFD..**

No.	A	A1	L	L1	L2	SW	VPE
TFD14	M14x1,5	M14x1,5	23	9	9	17	10
TFD14-1/4	M14x1,5	G 1/4	23	9	9	17	10
TFD1/4	G 1/4	G 1/4	23	9	9	17	10
TFD16	M16x1,5	M16x1,5	23	9	9	19	10
TFD16-3/8	M16x1,5	G 3/8	23	9	9	19	10
TFD3/8	G 3/8	G 3/8	23	9	9	19	10
TFD1/2-14	G 1/2	M14x1,5	27	12	9	22	10
TFD1/2-16	G 1/2	M16x1,5	27	12	9	22	10
TFD1/2	G 1/2	G 1/2	30	12	12	22	10
TFD24-1/2	M24x1,5	G 1/2	36	16	12	27	10
TFD3/4	G 3/4	G 3/4	40	16	16	27	10
TFD3/4-24	G 3/4	M24x1,5	40	16	16	27	10

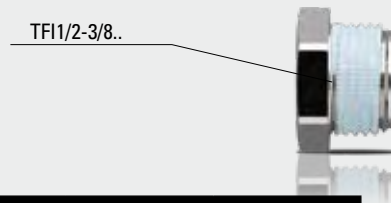
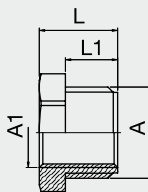

**TF..**

No.	A	A1	L	L1	SW	VPE
TF1/4-1/8	G 1/4	G 1/8	11	7	17	10
TF14-10	M14x1,5	M10x1	11	7	17	10
TF3/8-1/4	G 3/8	G 1/4	13	9	19	10
TF18-14	M18x1,5	M14x1,5	14	9	22	10
TF1/2-3/8	G 1/2	G 3/8	18	12	24	10
TF3/7-1/2	G 3/4	G 1/2	24	16	27	10
TF24-16	M24x1,5	M16x1,5	24	16	27	10

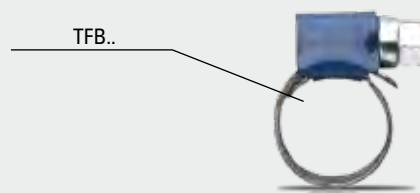

**TFB..**

No.	D	d	VPE
TFB0814	8-12	8	50
TFB1016	10-17	10	50
TFB1318	12-22	13	50
TFB2232	22-32	19	50

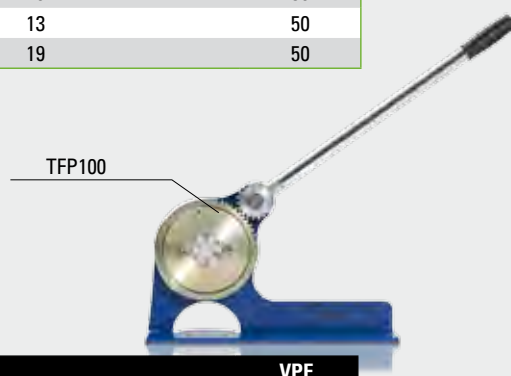

**TFP..**

No.	D	VPE
TFP100	10-36	1

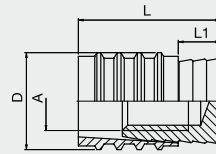
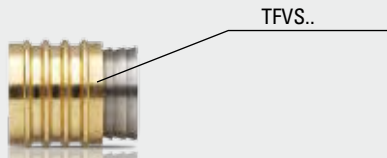

## TFVS..

No.	A	D	L	L1	VPE
TFVS6	M3	6	11,5	3,5	100
TFVS8	M4	8	11,5	3,5	100
TFVS10	M6	10	14	4	100
TFVS12	M6	12	14	4	100
TFVS16	M8	16	16	4	100

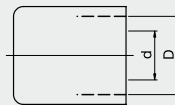
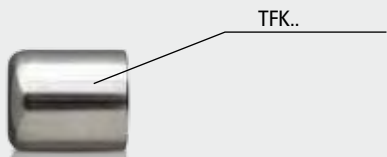

## TFK..

No.	D	d	VPE
TFK1510	15	10	100
TFK1610	16	10	100
TFK1810	18	10	100
TFK1913	19	13	100
TFK2013	20	13	100
TFK2313	23	13	100
TFK2919	29	19	50

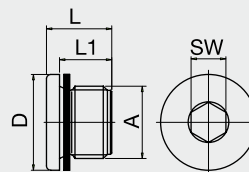

## TFL..

No.	A	D	L	L1	SW	VPE
TFLM10	M10x1	14	11	8	5	25
TFLR1/8	G 1/8	14	11	8	5	25
TFLM12	M12x1,5	17	15	12	6	25
TFLR1/4	G 1/4	18	15	12	6	25
TFLM14	M14x1,5	19	15	12	6	25
TFLR3/8	G 3/8	22	15	12	8	25
TFLR1/2	G 1/2	26	18	14	10	25

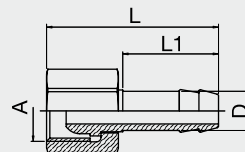
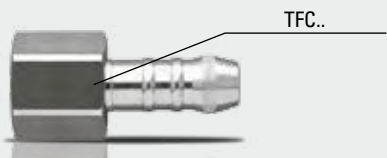

## TFC..

No.	A	D	L	L1	SW	VPE
TFC14	M14x1,5	9	39,5	22	17	10
TFC1/4	G 1/4	9	39,5	22	17	10
TFC16	M16x1,5	13	39	25	22	10
TFC3/8	G 3/8	13	39	25	22	10
TFC1/2	G 1/2	13	45	25	24	10
TFC24	M24x1,5	19	52	32	30	10
TFC3/4	G 3/4	19	52	32	32	10